

SMT Inductors

For Power Line

SDS Series SDS10145 Type

Special Features

- High current capacity
- Low DC resistance
- Low profile
- Magnetically shielded, can be used in high-density mounting
- Flat bottom surface ensures secure, reliable mounting
- Operating temperature -30 ~ 100 °C, including self-temperature rise

Applications

- Portable telephones, hard disk drives, personal computers, and other electronic equipment.

SHAPES AND DIMENSIONS/RECOMMENDED PC BOARD PATTERN

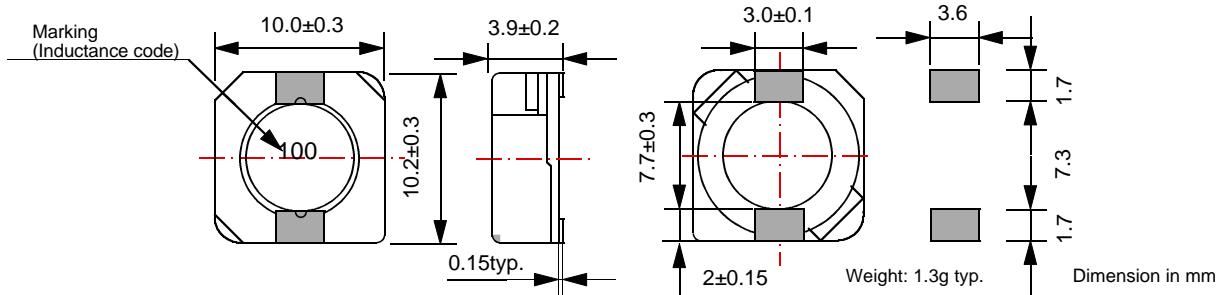

ELECTRICAL CHARACTERISTICS

Inductance (μ H)	Inductance tolerance (%)	Test frequency L(kHz)	DC resistance (Ω) max.	Rated current (A) *max.		Part No.
				Based on inductance change	Based on temperature rise	
8.2	±30	1	0.023	3.3	4.0	SDS10145-8R2N
10	±20	1	0.033	3.1	3.3	SDS10145-100M
12	±20	1	0.042	2.8	2.9	SDS10145-120M
15	±20	1	0.046	2.6	2.7	SDS10145-150M
18	±20	1	0.063	2.4	2.2	SDS10145-180M
22	±20	1	0.07	2.2	2.1	SDS10145-220M
27	±20	1	0.08	1.7	2.0	SDS10145-270M
33	±20	1	0.087	1.6	1.9	SDS10145-330M
39	±20	1	0.117	1.5	1.6	SDS10145-390M
47	±20	1	0.125	1.4	1.5	SDS10145-470M
56	±20	1	0.158	1.3	1.3	SDS10145-560M
68	±20	1	0.174	1.2	1.2	SDS10145-680M
82	±20	1	0.20	1.1	1.1	SDS10145-820M
100	±20	1	0.27	1.0	0.95	SDS10145-101M
120	±20	1	0.31	0.9	0.91	SDS10145-121M
150	±20	1	0.45	0.8	0.71	SDS10145-151M
180	±20	1	0.50	0.7	0.65	SDS10145-181M
220	±20	1	0.65	0.65	0.59	SDS10145-221M
270	±20	1	0.74	0.58	0.56	SDS10145-271M
330	±20	1	1.0	0.54	0.46	SDS10145-331M
390	±20	1	1.1	0.5	0.45	SDS10145-391M
470	±20	1	1.2	0.44	0.42	SDS10145-471M
560	±20	1	1.7	0.4	0.34	SDS10145-561M
680	±20	1	1.9	0.38	0.32	SDS10145-681M
820	±20	1	2.9	0.35	0.27	SDS10145-821M
1000	±20	1	3.2	0.26	0.26	SDS10145-102M

*Rated current: Value obtained when current flows and the temperature has risen to 30°C or when DC current flows and the initial value of inductance has fallen by 10%, whichever is smaller. All specifications are subject to change without notice.